



Comhairle Chontae Chill Chainnigh
Halla an Chontae Sraid Eoin Cill Chainnigh

Pobail agus Áiteanna Inbhuanaithe a Chruthú

Kilkenny County Council
County Hall John Street Kilkenny

Creating Sustainable Communities and Places



Ref: TC115

12th July 2021

TO: An Cathaoirleach
& Each Member of Kilkenny County Council

RE: Taking in Charge

Section 11 of the Roads Act, 1993
Section 180 of the Planning & Development Act, 2000
As amended by Section 59 of the Planning & Development Act 2010

Development: TC115 - Whitescastle, Whitescastle Lower, Knocktopher, Co. Kilkenny.

I attach herewith reports in relation to the taking in charge of the above residential development comprising of:

40 houses at Whitescastle, Whitescastle Lower, Knocktopher, Co. Kilkenny.

I recommend that the procedure required in accordance with Section 11 of the Roads Act, 1993 in order to facilitate the taking in charge of the roads in the above development and in accordance with Section 180 of the Planning & Development Act, 2000 as amended by Section 59 of the Planning & Development Act 2010, be commenced;

SIGNED:



Sean McKeown
Director of Services
Planning

Comhairle Chontae Chill Chainnigh
Kilkenny County Council
Planning Report



Planning & Development Acts, 2000 - 2020

Planning & Development Regulations, 2001 - 2020

**TAKING IN CHARGE REPORT FOR
ELECTED MEMBERS**

Planning Reference:	TC115
Development:	Whitescastle, Whitescastle Lower, Knocktopher, Co. Kilkenny
Developer:	South Eastern Construction Ltd.
Planning Permission Reference:	P.05/134 and P.14/50

Site Location & Description:

Whitescastle is a residential development of 40 houses plus 1 shop at Whitescastle Lower, Knocktopher, Co. Kilkenny. The site is served by a private water treatment plant and mains sewerage, and is accessed via a single entrance from regional road R699. All water services infrastructure on site (water and wastewater infrastructure) is being maintained by Kilkenny County Council Water Services Department.

Planning History:

P.05/134 - Permission granted for the construction of a housing development consisting of 14 detached houses, 10 semi-detached houses, 17 townhouses including 2 shop units and all associated ancillary accommodation and works, complete with new access onto existing public roadway on site.

P.14/50 - Permission granted for the completion of dwelling house at Site No 32 as previously granted under planning application Ref: 05/134 and all associated site works.

TIC Request:

The formal taking in charge application was received from the developer on 29th April 2014. Subsequent to this, the Planning Authority engaged with the developer to progress the process and complete the remedial works identified by the various service areas. Some works identified by the service areas were completed by the developer. However, the final works to bring the estate to taking in charge standard were arranged by Kilkenny County Council, the cost of which was recouped from the bond.

Recommendation:

Having regard to the completion of works identified by the various internal service areas, I recommend that Kilkenny County Council initiate proceedings for the formal taking in charge of Whitescastle, Whitescastle Lower, Knocktopher, Co. Kilkenny, as outlined on the attached map.

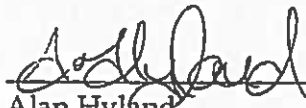

Alan Hyland,
TIC & BC Engineer, Planning.

Date: 12/07/21

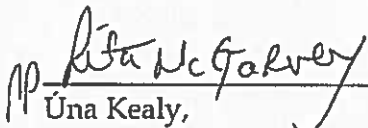

Una Kealy,
Administrative Officer, Planning.

Date: 12/07/2021

THIS IS A COMPUTER GENERATED MAP WITH ILM COORDINATES
OS MAP REF 5132 A & 5132 C

63492 637817

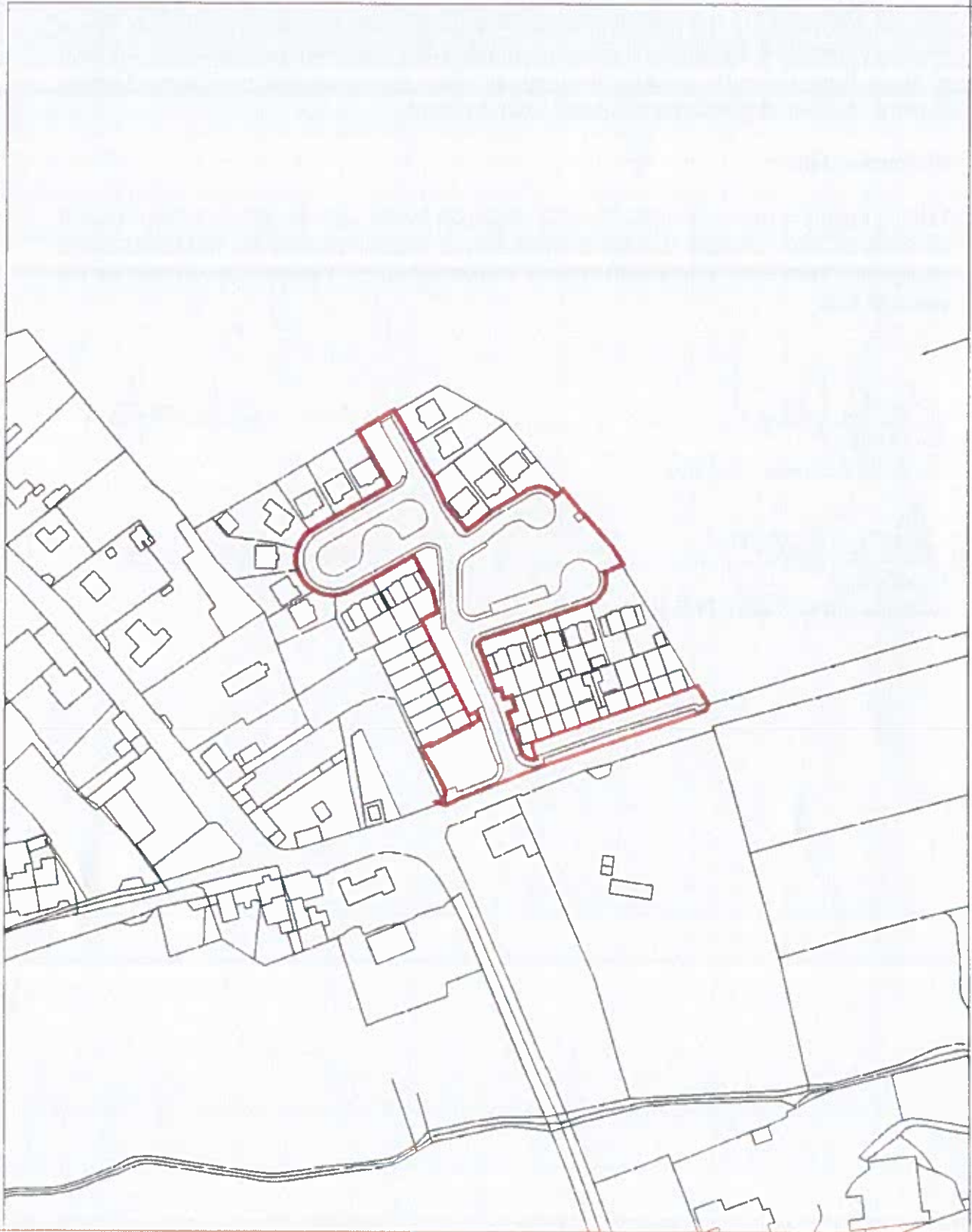

053051 677206

BASED ON ORDNANCE SURVEY OF IRELAND MAP. LICENCE NO KILKENNY CCMA 08/12

TAKING IN CHARGE
W/ TESCARTLE
KNOCKTOPHER
CO KILKENNY

FOR
INFORMATION
PURPOSES
ONLY

Comhairle Sheirín na Ceithre Rann at
Kilkenny County Council

